

WCDTK SERIES - WATER DEPTH TESTER KIT

It is the user's responsibility to determine the product's suitability for its intended use. For full details, visit Boshart Industries [Reference Documents](#) for our User Safety Responsibility Statement and other important documents.

APPLICATIONS:

- This is an accessory for premium Cast Iron watertight well caps for measuring the level of water that is in the well.
- NOTE: Ensure a stiffener is used in plastic tubing applications.

FEATURES:

- Available for 5" through 12" Pitless Units. Vertical (Top of Cap) installation for 5" & 6" caps. Horizontal (Side of Cap) installation available for 8", 10" & 12" caps.
- Can be field installed through the pitless unit's upper barrel. This design eliminates the need to remove and reinstall the depth tester plumbing each time the pump is removed for servicing.
- Adjustable dial ring.
- Body comes with two 1/4" FPT and one 1/8" FPT Ports.

SPECIFICATIONS:

- Assembly Includes:
 - PG45-WL; 4-1/2" water level gauge; No Fill
 - Depth Tester Body; 3/4"-16 UNF Screw thread, drilled through and tapped for (2) 1/4"-18 NPT tapered pipe thread and (1) 1/8"-27 NPT tapered pipe thread
 - 1/4" Air or Tank Valve (Heavy Spring general purpose core) included; Boshart part number SV-1NL
 - O-Rings (2): AS568-211 NBR O-Ring (ID 0.796" x OD 1.074" x CS 0.139")
 - 3/4" 18.8 S.S. Flat Washer (13/16" ID x 1-1/2" OD max)
 - 3/4"-16 UNF 18.8 S.S. Hex Nut (1-1/8" Flat to Flat)
 - 1/4" Compression x 1/4" MPT brass adapter; Boshart part number BC-68-0402

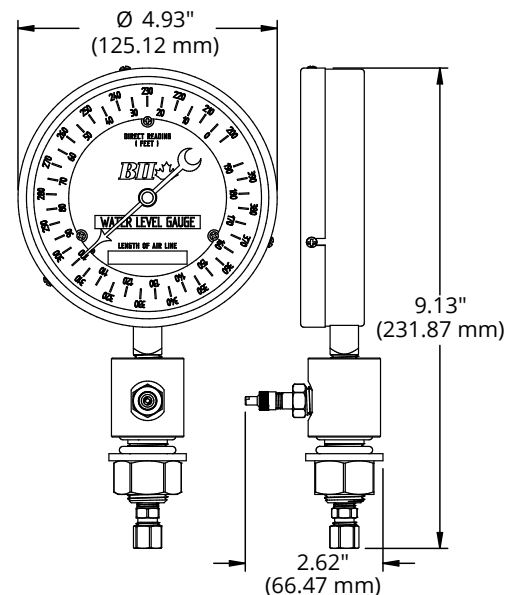
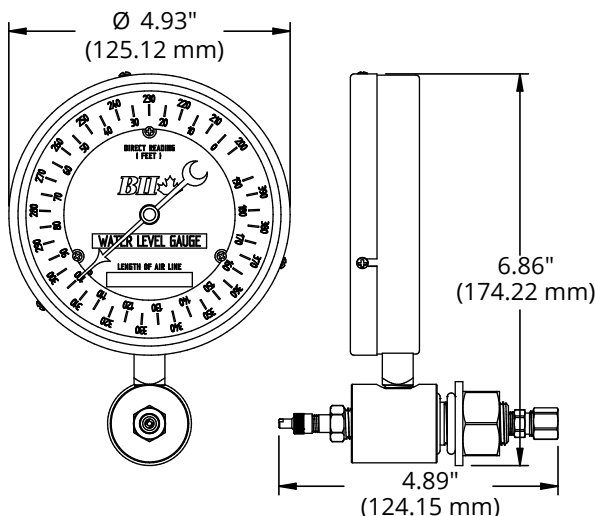
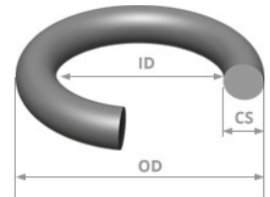

BOSHART
INDUSTRIES

25 Whaley Avenue, PO Box 310, Milverton, ON CANADA N0K 1M0
Tel: 800-561-3164

VISIT US ONLINE AT BOSHART.COM

For more information on installation, adjustment, repair & operation, visit Boshart Knowledge Base at SUPPORT.BOSHART.COM



Horizontal Installation

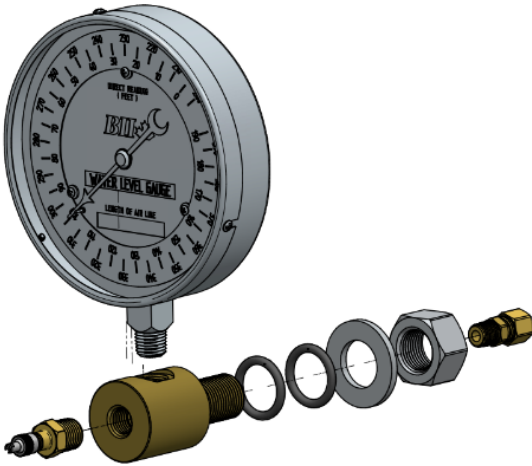

Vertical Installation

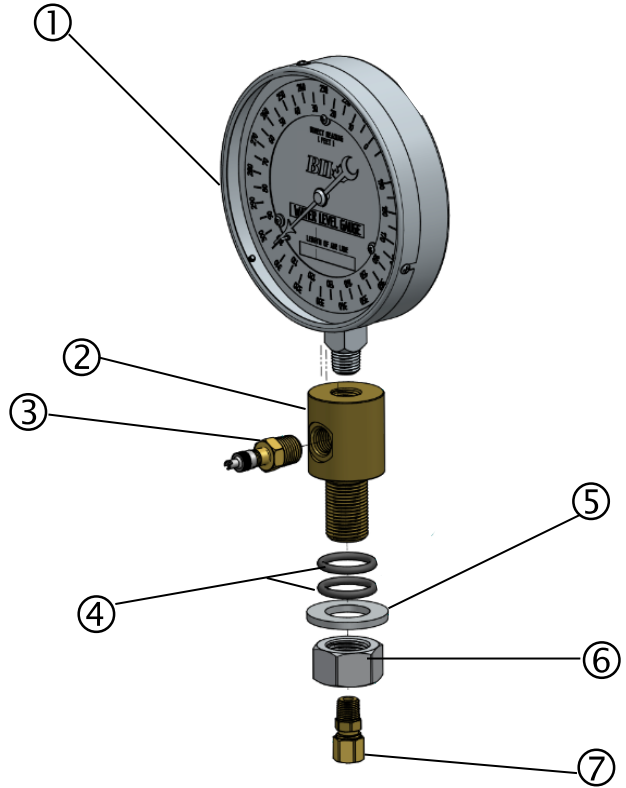

MATERIAL LIST

No	Part Name	Material		No	Part Name	Material	
1	Water Level Gauge (PG45-WL)	Case: 304 Stainless Steel		5	Flat Washer (B-WCDTK-W)	18.8 Stainless Steel	
		Dial: white aluminum					
		Connection: Brass					
		Bourdon Tube: Bronze					
		Lens: Acrylic					
2	Depth Tester Body (B-WCDTK-B)	Yellow Brass		6	Hex Nut (B-WCDTK-N)	18.8 Stainless Steel	
3	Air or Tank Valve (SV-1NL)	C6802 No Lead Brass		7	Brass Adapter (BC-68-0402)	C37700 Forged Brass	
4	O-rings (2) (B-OR-211)	NBR (Nitrile Butadiene/Buna-N Rubber)					

BOSHART
INDUSTRIES

25 Whaley Avenue, PO Box 310, Milverton, ON CANADA N0K 1M0
Tel: 800-561-3164

VISIT US ONLINE AT BOSHART.COM

For more information on installation, adjustment, repair & operation, visit Boshart Knowledge Base at SUPPORT.BOSHART.COM

