

TWU SERIES - TWISTED PUMP CABLE

APPLICATION:

- For use with submersible pumps installed in water wells in accordance with CSA C22.1 Canadian Electrical Code Part I

SPECIFICATION:

- Conductors: 14 AWG to 4 AWG bare copper
 TWUxx-4(S): 4 CONDUCTOR (Black,Red,Yellow,Green)
 TWUxx-3G(S): 3 CONDUCTOR (Black,Red,Green)
- Insulation: Polyvinyl chloride (PVC)

RATINGS:

- Voltage Rating: 600V
 - Temperature Rating: -40°F (-40°C) to 140°F (60°C)
 - Flame Rating: FT1
 - 300 meters (984 feet) length of cable on spool
- *The -40°C low temperature rating indicates that the cables have passed a cold impact test under carefully controlled laboratory conditions. These conditions may or may not reflect actual field conditions. It is therefore recommended that all cables be warmed to at least -10°C before installation.

CERTIFICATION:

- CSA Standard C22.2 No. 75 Certified

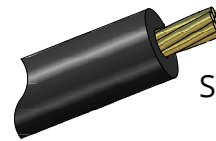

Stranded- 7 strands each conductor

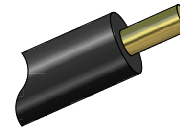

Solid- 1 strand each conductor

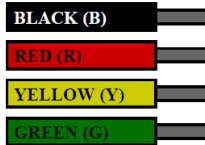

DIMENSIONS

Part No.	Circuit Conductors	Ground (Bonding Wire)	30°C Ambient Ampacity	Nominal Insulation Thickness		Nominal Cable Diameter		Nominal Cable Weight	
				inches	mm	inches	mm	lbs/mft	kg/km
SOLID									
TWU14-4S	Qty: 3 #14 (1) B,R,Y	14 (1) G	15	0.06	1.52	0.451	11.46	107	159
TWU14-3GS	Qty: 2 #14 (1) B,R	14 (1) G	15	0.06	1.52	0.403	10.24	80	119
TWU12-4S	Qty: 3 #12 (1) B,R,Y	12 (1) G	20	0.06	1.52	0.495	12.57	145	216
TWU12-3GS	Qty: 2 #12 (1) B,R	12 (1) G	20	0.06	1.52	0.442	11.23	109	162
STRANDED									
TWU14-4	Qty: 3 #14 (7) B,R,Y	14 (7) G	15	0.06	1.52	0.473	12.01	114	169
TWU14-3G	Qty: 2 #14 (7) B,R	14 (7) G	15	0.06	1.52	0.422	10.72	85	126
TWU12-4	Qty: 3 #12 (7) B,R,Y	12 (7) G	20	0.06	1.52	0.521	13.23	153	227
TWU12-3G	Qty: 2 #12 (7) B,R	12 (7) G	20	0.06	1.52	0.465	11.81	114	169
TWU10-4	Qty: 3 #10 (7) B,R,Y	10 (7) G	30	0.06	1.52	0.579	14.71	214	318
TWU10-3G	Qty: 2 #10 (7) B,R	10 (7) G	30	0.06	1.52	0.517	13.13	160	238
TWU8-4	Qty: 3 #8 (7) B,R,Y	10 (7) G	40	0.08	2.03	0.707	17.96	311	463
TWU6-4	Qty: 3 #6 (7) B,R,Y	8 (7) G	55	0.08	2.03	0.818	20.78	459	683
TWU4-4	Qty: 3 #4 (7) B,R,Y	6 (7) G	70	0.08	2.03	0.905	22.99	624	929

It is the sole responsibility of the end user to determine the product's suitability for its intended use. For full details, visit Boshart Industries [Reference Documents](#) for our User Safety Responsibility Statement and other important documents.



25 Whaley Avenue, PO Box 310, Milverton,
 ON CANADA N0K 1M0
 Tel: 800-561-3164

VISIT US ONLINE AT BOSHART.COM

For more information on installation, adjustment, repair & operation, visit Boshart Knowledge Base at SUPPORT.BOSHART.COM

