

BLM(H)C & GMC SERIES - BLACK & GALVANIZED MERCHANT COUPLINGS

APPLICATION:

Merchant couplings are best suited for low pressure applications. Commonly used in structural applications such as hand and safety railing construction. It is best practice to limit the use of these couplings to liquids not more hazardous than water.

COMBUSTABLE GAS WARNING: *Straight Taped (NPS) coupling MUST NOT be used in pipelines for transfer of combustible gases such as but not limited to; Acetylene, Butane, Natural Gas, Propane. Many suppliers state that the merchant coupling applications include gas lines, however it is not clear if this is limited to inert / non-combustible gases or if they also mean combustible gases. DO NOT USE without approval from your local gas inspector. The information below is to be used as a guide only, it is not a recommendation for the application of our product. It is the sole responsibility of the end user to determine the product's suitability for its intended use. For full details, visit Boshart Industries [Reference Documents](#) for our User Safety Responsibility Statement and other important documents.*

FEATURES:

- Merchant couplings are seamless.
- BLMC & GMC series Full Merchant couplings are chamfered on both ends, threaded all the way through up to 2", larger sizes taper tapped.
 - Black full couplings are finished with black lacquer for additional corrosion protection, Galvanized full couplings are zinc coated by electroplating.
- BLMHC series Half Merchant couplings are threaded all the way through; one end is chamfered, the other end is square cut for welding.
 - Black half couplings are made with a blasted finish. The black laquer applied to black full couplings would emit smoke emissions and cannot be used in a welding applications.



SPECIFICATIONS & RATINGS:

- Dimensions and materials conform to ASTM A865 (Standard Specification for Threaded Couplings, Steel, Black or Zinc-Coated (Galvanized) Welded or Seamless, for Use in Steel Pipe Joints).
- Steel material meets ASTM A530 (Standard Specification for General Requirements for Specialized Carbon and Alloy Steel Pipe).
- Threads conform to ANSI/ASME B1.20.1 (Pipe Threads, General Purpose, Inch).
- Straight Tapped (NPS) threaded coupling sizes 1/8" - 2" are rated for a 150 PSI / 150°F maximum*.
- Taper Tapped (NPT) threaded coupling sizes 2-1/2" - 8" are rated for a 300 PSI / 150°F maximum*.

*These are generally accepted industry pressure / temperature ratings to be used as a guide only. The ASTM A865 Standard does not provide pressure / temperature ratings. Since the specific service conditions and applicable codes or regulations which apply to the user's application are unknown and vary we are unable to provide a definite answer.

CERTIFICATION:

- NSF/ANSI Standard 372 Certified (Drinking Water System Components - Lead Content)*
*GMC series only

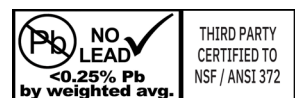

BOSHART
INDUSTRIES

25 Whaley Avenue, PO Box 310, Milverton, ON CANADA N0K 1M0
Tel: 800-561-3164

VISIT US ONLINE AT BOSHART.COM



STRAIGHT TAPPED FULL COUPLING DIMENSIONS										
Part No.		Size	W		L		Weight			
							Black		Galv	
Black	Galv		in	mm	in	mm	lbs	g	lbs	g
BLMC-01	GMC-01	1/8"	0.56	14.3	0.75	19.1	0.03	12.7	0.03	13.6
BLMC-02	GMC-02	1/4"	0.72	18.3	1.13	28.6	0.06	29.0	0.07	30.8
BLMC-03	GMC-03	3/8"	0.88	22.2	1.13	28.6	0.09	41.7	0.09	40.8
BLMC-05	GMC-05	1/2"	1.06	27.0	1.50	31.1	0.17	76.2	0.17	78.0
BLMC-07	GMC-07	3/4"	1.31	33.4	1.56	39.7	0.26	117.0	0.26	119.7
BLMC-10	GMC-10	1"	1.58	40.0	1.94	49.2	0.39	178.7	0.40	179.6
BLMC-12	GMC-12	1-1/4"	1.90	48.3	2.00	50.8	0.46	209.6	0.46	208.7
BLMC-15	GMC-15	1-1/2"	2.20	55.9	2.00	50.8	0.66	297.6	0.67	302.1
BLMC-20	GMC-20	2"	2.75	69.9	2.06	52.4	0.97	441.8	0.98	443.6
TAPER TAPPED FULL COUPLING DIMENSIONS										
BLMC-25	GMC-25	2-1/2"	3.25	82.6	3.06	77.8	2.25	1020.6	2.21	1003.3
BLMC-30	GMC-30	3"	4.00	101.6	3.19	81.0	3.32	1505.0	3.27	1482.3
BLMC-35	-	3-1/2"	4.63	117.5	3.31	84.2	4.81	2181.8	-	-
BLMC-40	GMC-40	4"	5.00	127.0	3.44	87.3	4.67	2120.1	4.63	2098.3
BLMC-50	-	5"	6.29	159.8	3.69	93.7	8.44	3826.5	-	-
BLMC-60	GMC-60	6"	7.39	187.7	3.94	100.0	11.06	5016.7	11.43	5184.6
BLMC-80	-	8"	9.63	244.5	4.19	106.4	20.36	9235.1	-	-

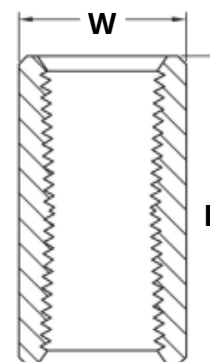
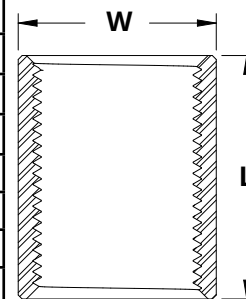

BLACK STRAIGHT TAPPED HALF COUPLING DIMENSIONS								
Part No.	Size	Thread	W		L		Weight	
			in	mm	in	mm	lbs	g
BLMHC-01	1/8"	Straight	0.56	14.3	0.53	13.5	0.01	6.4
BLMHC-02	1/4"	Straight	0.72	18.3	0.53	13.5	0.03	12.7
BLMHC-03	3/8"	Straight	0.88	22.2	0.53	13.5	0.04	19.1
BLMHC-05	1/2"	Straight	1.06	27.0	0.72	18.3	0.08	36.3
BLMHC-07	3/4"	Straight	1.31	33.4	0.75	19.1	0.12	53.5
BLMHC-10	1"	Straight	1.58	40.0	0.94	23.8	0.19	85.3
BLMHC-12	1-1/4"	Straight	1.90	48.3	0.97	24.6	0.21	97.1
BLMHC-15	1-1/2"	Straight	2.20	55.9	0.97	24.6	0.31	138.8
BLMHC-20	2"	Straight	2.75	69.9	1.00	25.4	0.48	215.9
BLACK TAPER TAPPED HALF COUPLING DIMENSIONS								
BLMHC-25	2-1/2"	Taper	3.25	82.6	1.50	38.1	1.04	469.9
BLMHC-30	3"	Taper	4.00	101.6	1.56	39.7	1.61	732.1
BLMHC-35	3-1/2"	Taper	4.63	117.5	1.63	41.3	1.98	898.1
BLMHC-40	4"	Taper	5.00	127.0	1.69	42.9	2.31	1046.9
BLMHC-50	5"	Taper	6.29	159.8	1.75	44.5	4.13	1874.2
BLMHC-60	6"	Taper	7.39	187.7	1.88	47.6	5.38	2442.1
BLMHC-80	8"	Taper	9.63	244.5	2.09	53.2	9.67	4387.1

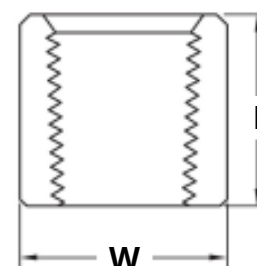
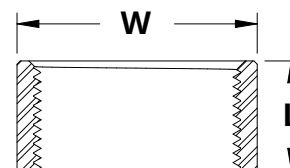

BOSHART
INDUSTRIES

25 Whaley Avenue, PO Box 310, Milverton, ON CANADA N0K 1M0
Tel: 800-561-3164

VISIT US ONLINE AT BOSHART.COM

For more information on installation,
adjustment, repair & operation, visit
Boshart Knowledge Base at
SUPPORT.BOSHART.COM

