

# WTCL-C SERIES WELL CAP INSTRUCTIONS



Series: WTCL-C  
Installation Instructions

## Installation Instructions for WTCL-C Series (8, 10, & 12" Pitless Units) Premium Watertight Well Caps



WTCL-C12



WTCL-C12  
(Without Lid)

### Required tools:

(1) 3/4" wrench, (1) Ratchet with 3/4" socket & (1) 5/32" allen wrench



WTCL-C10

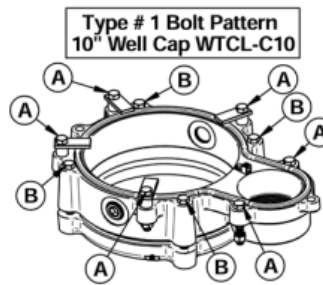

Type # 1 Bolt Pattern  
10" Well Cap WTCL-C10

- A - 1/2"-13 UNC X 3" Long S.S. Hex. Head Bolts with Hex Nuts
- Type #1: 6 Places
- Type #2: 8 Places

- A - 1/2"-13 UNC X 5" Long S.S. Hex. Head Bolts with Square Nuts
- Type #1: 4 Places
- Type #2: 8 Places

Type # 2 Bolt Pattern  
12" & 14" Well Caps WTCL-C12, & C14

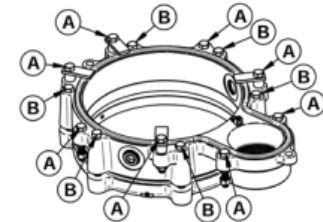

**STEP 1** - The lower assembly will come out of the bottom of the well cap as assembled as shown in Fig. A. Using a 3/4" wrench, loosen the B bolts (4 Places Type #1, 6 Places Type #2) which hold the center ring and the lower ring castings together (Fig. A) until there is no compression on the rubber casing gasket seal.

**NOTE:** Do **NOT** remove the square nuts. The nuts are recessed into the lower ring casting to ensure the well cap is tamper proof, the nuts will not turn when tightening the bolts.

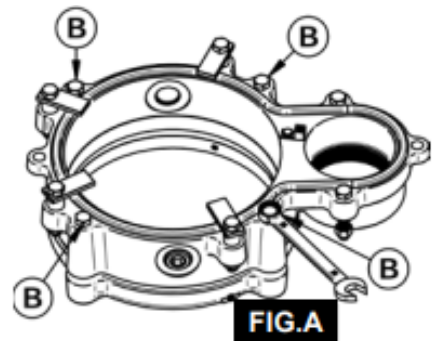

FIG.A

# WTCL-C SERIES WELL CAP INSTRUCTIONS



Series: WTCL-C  
Installation Instructions

**STEP 2** - Place lower assembly onto the well casing (Fig. B) and slide down until the casing contacts the 4 tabs bolted to the top of the middle ring casting (Fig. C).

**NOTE:** Casing should be cut off straight, and be free of burrs to ensure a proper fit.

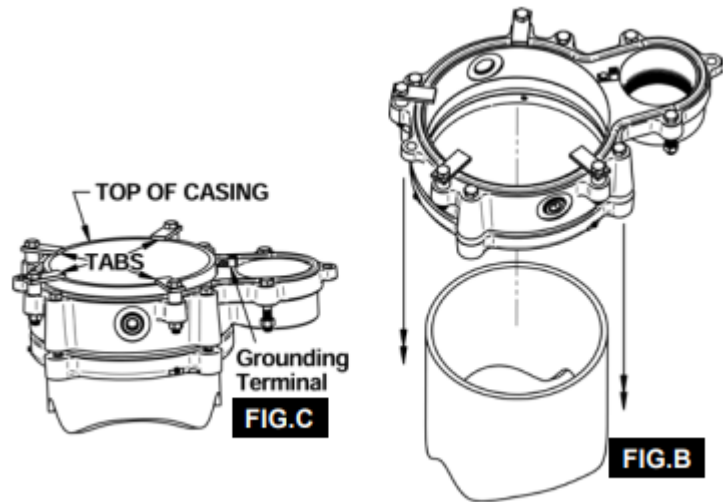

**STEP 3** - Hand tighten the B bolts (4 Places Type #1, 6 Places Type #2), then tighten an additional 2 turns in the cross corner type sequence shown (Fig. D) to compress the casing gasket equally between the lower and middle ring to make a watertight seal.

**NOTE:** The lower well cap assembly will be secure, you should not be able to twist or lift the lower assembly by hand. If the lower assembly can be moved, tighten each bolt one additional turn, and repeat until the assembly is tight on the well casing.

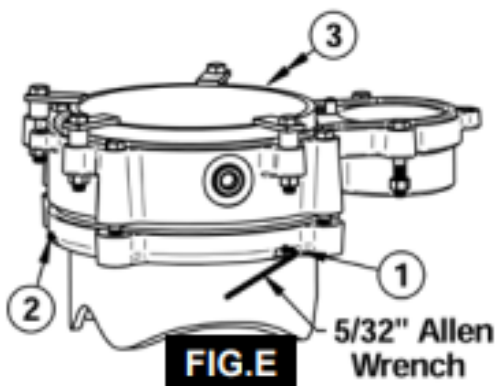
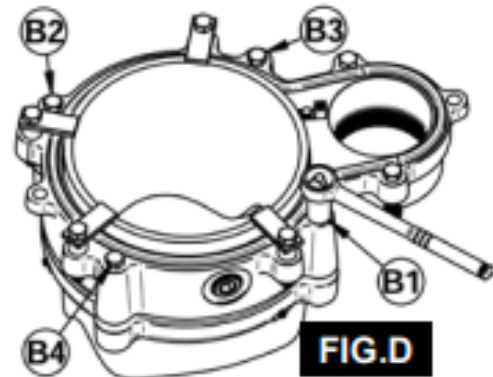

**STEP 4** - Tighten three grounding set screws in the lower ring (Fig. E) using a 5/32" allen wrench.

**NOTE:** Grounding set screws are only effective in steel well casing applications.

**Caution:** Grounding requirements may vary depending on provincial, state or local electrical codes. Always check and follow your local electrical codes, and contact your electrical inspector for details.

# WTCL-C SERIES WELL CAP INSTRUCTIONS



Series: WTCL-C  
Installation Instructions

**STEP 5** - Remove the A bolts and nuts, (6 Places Type #1, 8 Places Type #2) along with the 4 sets of tabs and spacers (Fig. F).

**NOTE:** Keep the A bolts and nuts. They will be needed later to bolt the top cover on. The tabs and spacers can be discarded (Fig. G).

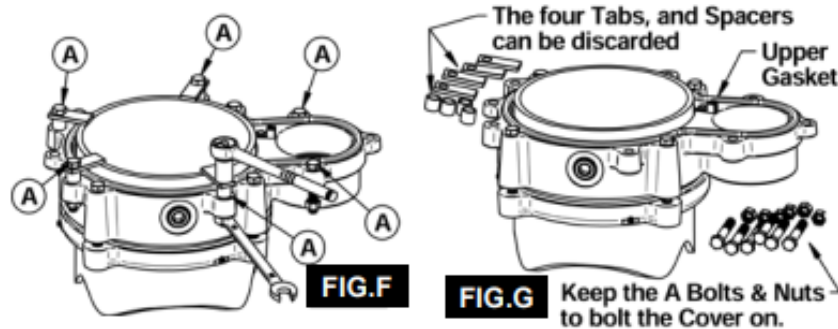

**STEP 6** - Make sure that the Upper Gasket is seated properly in the groove on the top of the middle ring (Fig. G).

**STEP 7** - Thread the 2" MPT vent cap, the 2" MPT test cap, and the 1-1/2" MPT test cap (Fig. H) into the top cover. Ensure that they are threaded in deep enough to allow installation of the S.S. cotter keys through the holes in the lower portion of the threads (Fig. I). These cotter keys ensure that the vent and caps cannot be removed maintaining the integrity of the locking / tamper proof design of the well cap.

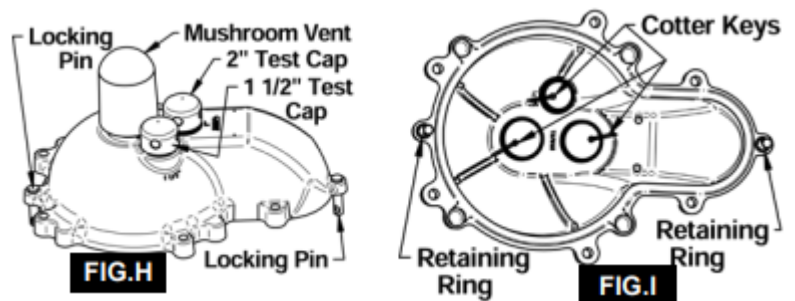

**STEP 8** - Place the 2 locking pins through the end holes in the cap, (Fig. H) and slide the retaining rings over the locking pins from the bottom (Fig. I). This will keep the locking pins from falling out of the cover when the cover is removed.

# WTCL-C SERIES WELL CAP INSTRUCTIONS



Series: WTCL-C  
Installation Instructions

**STEP 9** - Place top cover on the lower assembly. Make sure that all the holes align and it is completely down over the sealing gasket. The two locking pins should go through the end holes in the middle ring. Place the A Bolts and Nuts through the top cover and middle ring hand tight only (six places type #1, eight places type #2). Using the ratchet with a 3/4" socket and a 3/4" wrench tighten all bolts an additional two turns in the cross corner sequence as illustrated in FIG.J, ensuring that the gasket is compressed evenly between the castings all the way around. DO NOT overtighten.

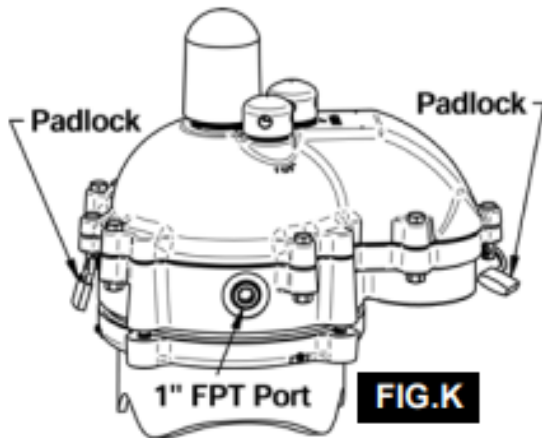
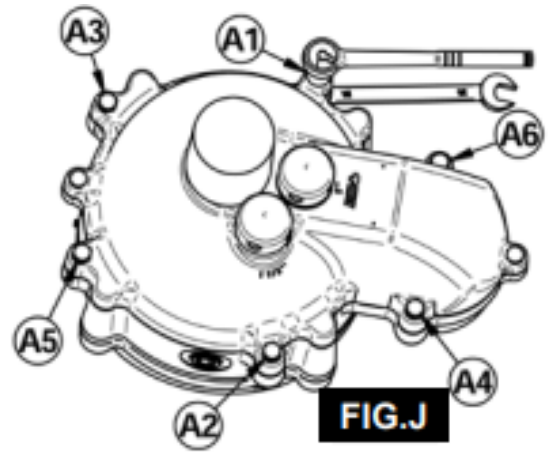

**STEP 10** - Insert padlocks through the locking pin holes (FIG. K) at both ends.

**NOTE:** Padlocks are not included. It is recommended to use 1/4" diameter "U" shank locks.

**NOTE:** There is a 1" FPT Port in the middle ring on both sides that can be used to install additional accessories such as chlorinators or sensor etc.

For more information on installation, adjustment, repair & operation, visit Boshart Knowledge Base at

[SUPPORT.BOSHART.COM](http://SUPPORT.BOSHART.COM)

