

INSTALLATION INSTRUCTIONS FOR WTC SERIES TWO PIECE LOCKING WELL CAPS FOR STEEL & PVC CASING

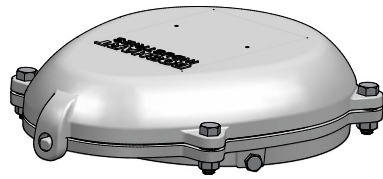

WTC-Axxx
Aluminum Series

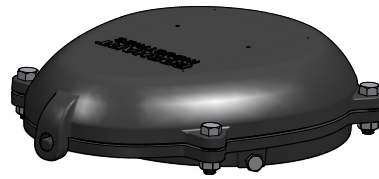

WTC-Cxxx
Cast Iron Series

STEP #1

Make sure the well casing is cut off with a clean level cut and free of burrs and foreign debris.

STEP #2

Take O-Ring and stretch it over the casing keeping it flush with the top of the casing



STEP #3

Fully retract the set screws using a 7/16" wrench, then place bottom ring over O-Ring,
WARNING: Failure to retract all set screws may result in cutting the O-Ring.

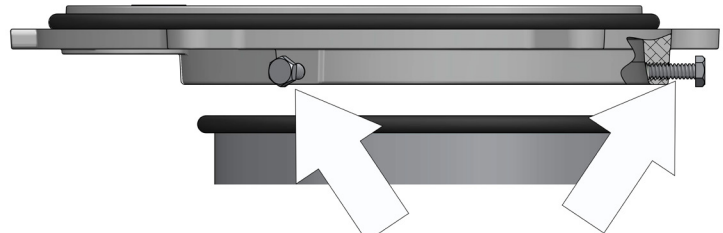
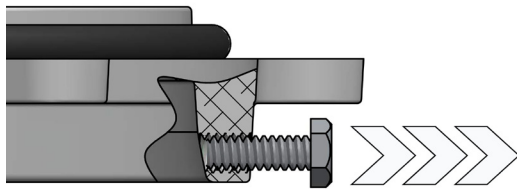

IMPORTANT! Retract ALL Set Screws

STEP #4

Push down on bottom ring, the O-Ring will roll inside the tapered section and compress the O-ring between the ring and the well casing. Continue pushing down until the top of the bottom ring is flush with the top of the casing.

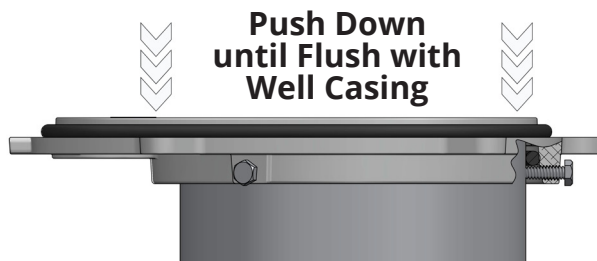

**Push Down
until Flush with
Well Casing**

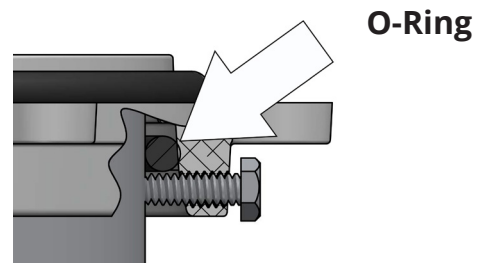

O-Ring

STEP #5

Finger tighten the set screw bolts, then wrench tighten in small 1/4 turn increments in sequence to ensure equal force for each set screw. Repeat a second time to a maximum of 1/2 turn wrench tight in total on each bolt..

Caution:

Do not overtighten

If the set screws are not tighten in sequence it may cause the bottom ring to distort

BOSHART
INDUSTRIES

25 Whaley Avenue, PO Box 310, Milverton, ON CANADA N0K 1M0
Tel: 800-561-3164

boshart.com ♦ blog.boshart.com

INSTALLATION INSTRUCTIONS FOR WTC SERIES TWO PIECE LOCKING WELL CAPS FOR STEEL & PVC CASING

STEP #6

Hook the cap cover onto the front pin and then lower the rear of the cap down onto the O-Ring aligning the bolt holes.

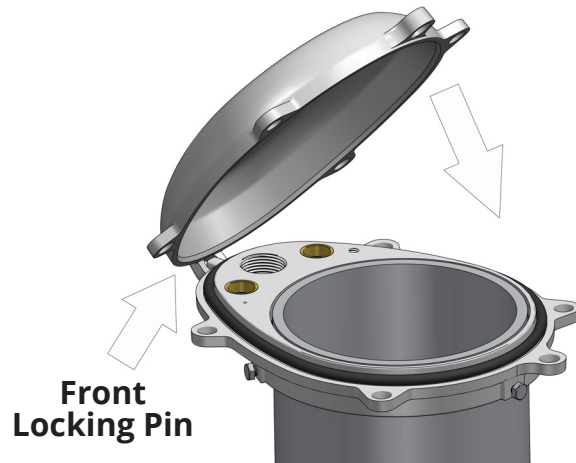

STEP #7

Replace the 5 sets of 3/8" nuts and bolts and finger tighten. Then tighten bolts in small 1/4 turn increments in the sequence as illustrated, ensuring that the castings touch evenly between the bolts all the way around. DO NOT over tighten. You will be able to feel when the two metal halves touch.

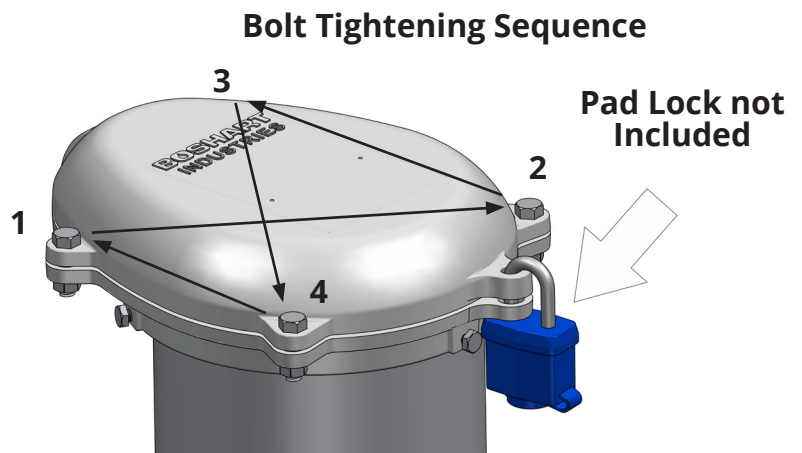

STEP #8

OPTIONAL - Insert pad lock through both the locking tabs in the top cover and the bottom ring and lock to prevent and tampering with the well. NOTE: Pad Lock is not included!

BOSHART
INDUSTRIES

© 2020 Boshart Industries Inc. All Rights Reserved.

25 Whaley Avenue, PO Box 310, Milverton, ON CANADA N0K 1M0
Tel: 800-561-3164

boshart.com ♦ blog.boshart.com

IOM-WTC-APR.21.2023