

29-CC SERIES PVC COMPRESSION COUPLING IRON & PVC PIPE SIZE

SPECIFICATION:

- For use as a repair coupling on piping systems with iron pipe size according to ASME/ANSI B36.10
- Max Temperature Rating: 140°F (60°C)
- Max Pressure Rating: 150 PSI @ 73°F(22°C)
- Durable construction

CAUTION:

- Pipes must be properly restrained or end blocked to prevent blow off after installation.

WARNING:

- Not for use in compressed air or gas systems. Do not test system with compressed air or gases.

CERTIFICATION:

- NSF/ANSI Standard 61 & 372 Certified

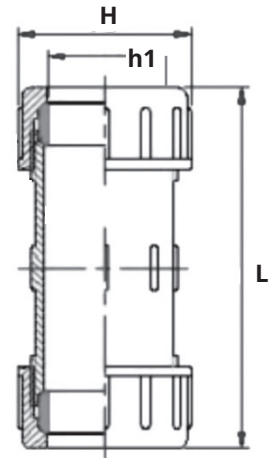
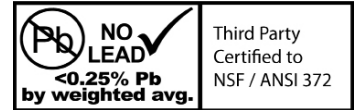

MATERIAL LIST	
Name	Material
Body	UPVC
Union Nut	UPVC
Seat	Nitrile Rubber
Seal	Nitrile Rubber

DIMENSIONS								
Part No.	Nominal Size	H		h1		L		Weight grams
		inches	mm	inches	mm	inches	mm	
29-CC05	1/2"	1.83	46.50	0.83	21.00	5.24	133.00	130
29-CC07	3/4"	2.05	52.00	1.04	26.47	5.28	134.10	160
29-CC10	1"	2.40	61.00	1.31	33.20	5.83	148.00	230
29-CC12	1-1/4"	2.83	72.00	1.65	42.00	6.42	163.00	250
29-CC15	1-1/2"	3.15	80.00	1.89	48.00	6.83	173.50	420
29-CC20	2"	3.62	92.00	2.37	60.10	7.87	200.00	550
29-CC25	2-1/2"	4.53	115.00	2.87	72.80	9.76	248.00	1090
29-CC30	3"	5.28	134.00	3.49	88.70	10.75	273.00	1500
29-CC40	4"	6.34	161.00	4.49	114.10	11.95	303.50	2270
29-CC60	6"	8.78	223.00	6.61	168.00	11.02	280.00	3600

TEMPERATURE CORRECTION FACTOR FOR PVC VALVES

As temperature increases, working pressure decreases. The optimal working pressure for PVC valves is 150 PSI @ 73°F (22°C). If the temperature increases above 73°F (22°C), use the PVC correction factor to determine working pressure. Multiply the maximum working pressure by the correction factor.

Temperature	73°F (22°C)	90°F (32°C)	100°F (38°C)	110°F (38°C)	120°F (49°C)	130°F (54°C)	140°F (60°C)
PVC Correction Factor	1.00	1.00	1.00	0.83	0.66	0.50	0.33

BOSHART
INDUSTRIES

25 Whaley Avenue, PO Box 310, Milverton, ON CANADA N0K 1M0
Tel: 800-561-3164

boshart.com ♦ blog.boshart.com