

0853(F)-NL & 0851P-NL SERIES NO LEAD BRASS SEDIMENT FAUCETS

SPECIFICATION:

- Inlet Threads conform to ANSI/ASME B1.20.1
- Crimp PEX ends conform to ASTM F-1807
- Solder ends comply with ANSI B16.18
- 0853-05NL has combination MPT & 1/2" solder inlet connection
- Hose thread outlet 3/4" GHT
- Max Pressure Rating: 125 PSI
- Max Temperature Rating: 180°F (82°C)
- Black cast hand wheel

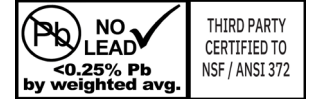

CERTIFICATION:

- NSF/ANSI Standard 61 & 372 Certified
- CSA Standard B125.1 Certified



Material List		
Part No.	Part Name	Material
1	Body	C46400 No Lead Brass
2	Seat Packing Screw	SS304 Stainless Steel
3	Seat Packing	NBR-Rubber
4	Bonnet	C46400 No Lead Brass
5	Packing Nut	C36000 Brass
6	Gland Packing	NBR-Rubber
7	Stem	C46400 No Lead Brass
8	HandWheel Nut	Brass Plated Steel
9	Name Plate	Aluminum
10	Hand Wheel	Black Powder coated Cast Iron
11	Pex Fitting	C46400 No Lead Brass

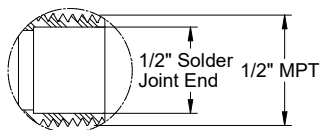
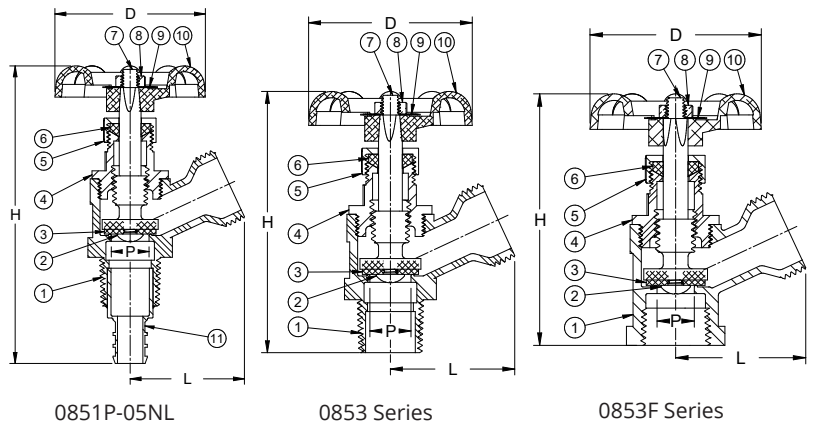

0853-05NL Inlet End

DIMENSIONS										
Part No.	Inlet Description	P		D		H		L		Weight grams
		inches	mm	inches	mm	inches	mm	inches	mm	
0853-05NL	1/2" MPT X C	0.52	13.20	2.07	52.50	3.28	83.30	1.58	40.00	241
0853-07NL	3/4" MPT	0.52	13.20	2.07	52.50	3.32	84.33	1.58	40.00	258
0853F-05NL	1/2" FPT	0.52	13.20	2.07	52.50	3.05	74.47	1.58	40.00	238
0853F-07NL	3/4" FPT	0.52	13.20	2.07	52.50	3.10	78.74	1.58	40.00	251
0851P-05NL	1/2" Crimp PEX or MPT	0.52	13.20	2.07	52.50	4.06	103.12	1.58	40.00	236



25 Whaley Avenue, PO Box 310, Milverton, ON CANADA N0K 1M0
Tel: 800-561-3164

boshart.com ♦ blog.boshart.com