

17CVNL SERIES - NL BRONZE THREADED CHECK VALVE

SPECIFICATIONS:

- Threads conform to ANSI/ASME B1.20.1
- Maximum pressure rating: 200 PSI
- 200 PSI WOG Non-Shock - WOG pressure rating based on ambient temperature
- Maximum temperature rating: 180 °F (82 °C)
- Cast NL bronze body and poppet
- NBR O-ring seal
- Cracking pressure equal to or less than 0.5 PSI for 1/2" through 4" valves

CERTIFICATION:

- NSF/ANSI 372 Certified

MATERIAL LIST	
Part Name	Material
Hex Nut	304SS
Cup Washer	304SS
Spring	304SS
Bushing	Polyethylene
Body	NL Bronze (C89844)
O-ring	Nitrile Butadiene Rubber (NBR)
Poppet	NL Bronze (C89844)

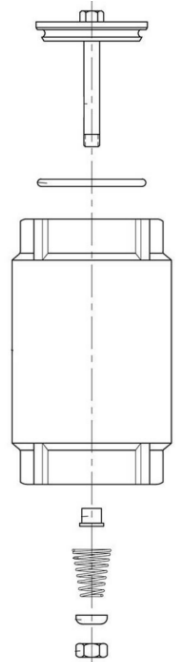
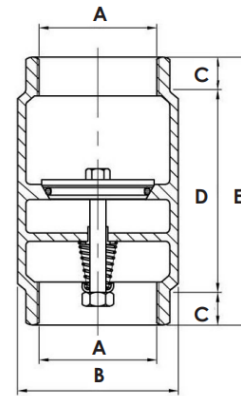
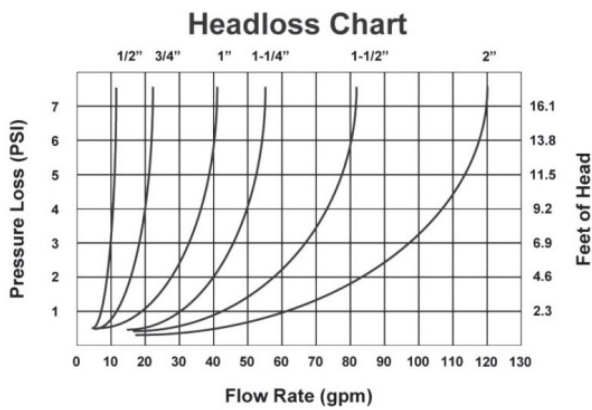
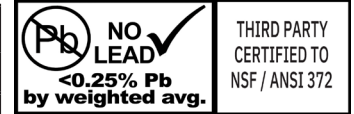

Part No.	DIMENSIONS									
	A	B		C		D		E		Weight grams
		in	mm	in	mm	in	mm	in	mm	
17CV050NL	1/2" FPT	1.22	30.99	0.37	9.49	1.61	41.00	2.36	59.99	190
17CV075NL	3/4" FPT	1.45	37.01	0.39	10.01	1.85	46.99	2.63	67.00	270
17CV100NL	1" FPT	1.73	43.99	0.45	11.51	2.24	57.00	3.15	80.01	390
17CV125NL	1-1/4" FPT	2.08	53.01	0.53	13.49	2.48	62.99	3.54	89.99	600
17CV150NL	1-1/2" FPT	2.36	59.99	0.61	15.49	2.82	71.70	3.93	100.00	750
17CV200NL	2" FPT	2.95	75.01	0.65	16.51	3.42	87.00	4.72	119.99	1400
17CVMF-125-100NL	1" FPTx1-1/4" MPT	1.73	43.99	0.45	11.51	2.24	57.00	3.15	80.01	380

For more information on installation, adjustment, repair & operation, visit Boshart Knowledge Base at

SUPPORT.BOSHART.COM



BOSHART
INDUSTRIES

25 Whaley Avenue, PO Box 310, Milverton, ON CANADA N0K 1M0
Tel: 800-561-3164

boshart.com ♦ blog.boshart.com