

28-BFVRSS SERIES STAINLESS STEEL FLOAT RODS (THREADED)

SPECIFICATION:

- Threads conform to ANSI B1.1
- Material: Stainless Steel

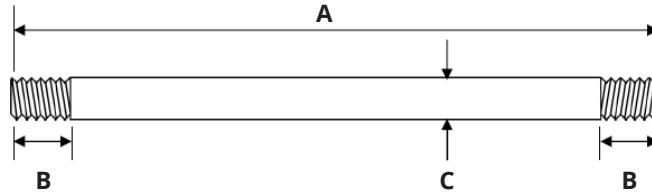

DIMENSIONS										
Part No.	Length	Fits Valve	Thread Size	A		B		C		Weight grams
				inches	mm	inches	mm	inches	mm	
28-BFVRSS-045	4.5"	Use to connect 3/8" through 1" float valves with float balls up to and including 6" diameter	1/4" - 20 SAE	4.50	114.30	0.56	14.29	0.25	6.35	29
28-BFVRSS-06	6"		1/4" - 20 SAE	6.00	152.40	0.56	14.29	0.25	6.35	40
28-BFVRSS-08	8"		1/4" - 20 SAE	8.01	203.20	0.56	14.29	0.25	6.35	50
28-BFVRSS-10	10"		1/4" - 20 SAE	10.01	254.00	0.56	14.29	0.25	6.35	55
28-BFVRSS-12	12"		1/4" - 20 SAE	12.01	304.80	0.56	14.29	0.25	6.35	85
28-BFVRSS3814-10	10"	Use to connect 3/8" through 1" float valves with 8" or larger float balls; or 1-1/4" through 2" float valves with 6" or smaller float balls.	1/4" - 20 SAE	10.01	254.00	0.56	14.29	0.37	9.50	142
28-BFVRSS3814-12	12"		1/4" - 20 SAE	12.01	304.80	0.56	14.29	0.37	9.50	171
28-BFVRSS3814-14	14"		1/4" - 20 SAE	14.01	355.60	0.56	14.29	0.37	9.50	200
28-BFVRSS3814-16	16"		1/4" - 20 SAE	16.01	406.40	0.56	14.29	0.37	9.50	230
28-BFVRSS38-10	10"	Use to connect 1-1/4" through 2" float valves with 8" and larger float balls.	1/4" - 20 SAE	10.01	254.00	0.56	14.29	0.37	9.50	146
28-BFVRSS38-12	12"		1/4" - 20 SAE	12.01	304.80	0.56	14.29	0.37	9.50	180
28-BFVRSS38-14	14"		1/4" - 20 SAE	14.01	355.60	0.56	14.29	0.37	9.50	203
28-BFVRSS38-16	16"		1/4" - 20 SAE	16.01	406.40	0.56	14.29	0.37	9.50	232



25 Whaley Avenue, PO Box 310, Milverton, ON CANADA N0K 1M0
Tel: 800-561-3164

boshart.com ♦ blog.boshart.com